

**OPERATING NUT WITH
O-RING PLATE**

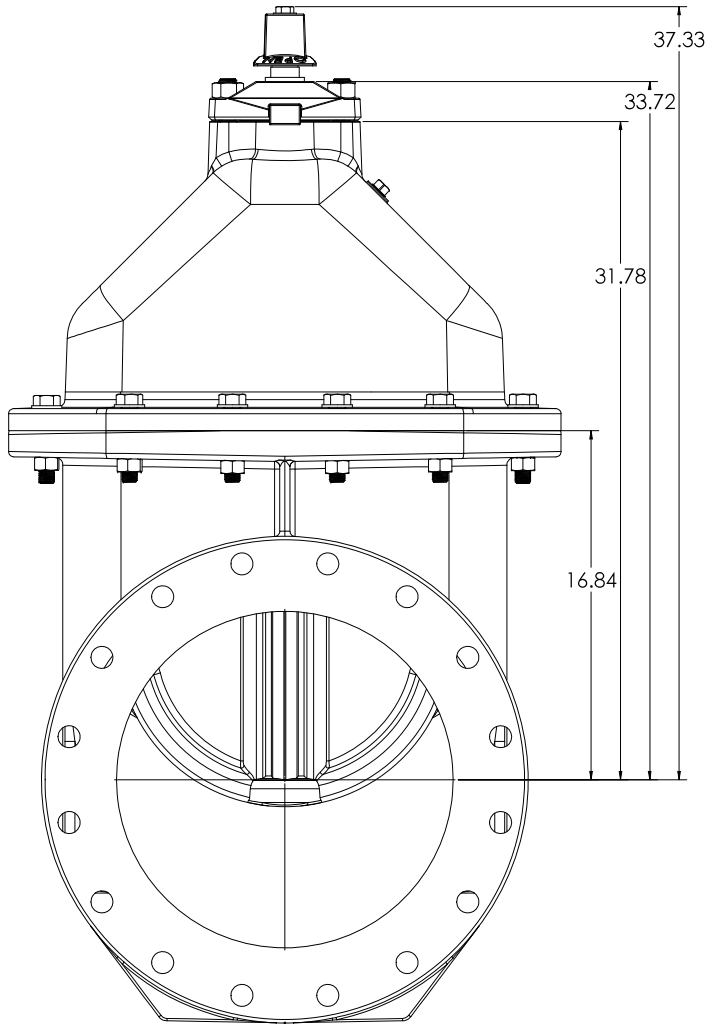

**OPERATING NUT WITH INDICATOR
POST PLATE**

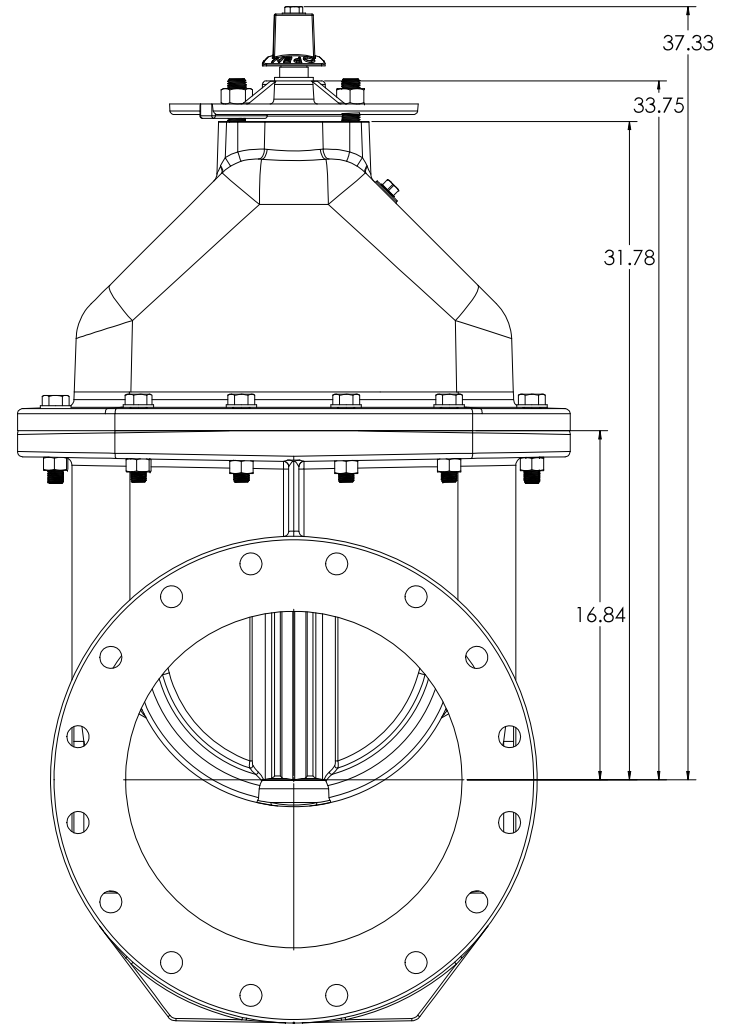

COMPANY: 16" GATE VALVE DATE: 12/4/2009 DRAWN BY: CW CHECKED BY:	PROJECT: 16" CS18 NRS RESILIENT WEDGE GATE VALVE SCALE: 1:3 SHEET NO: 2 TOTAL SHEETS: 6	
--	--	--

HANDWHEEL WITH O-RING PLATE

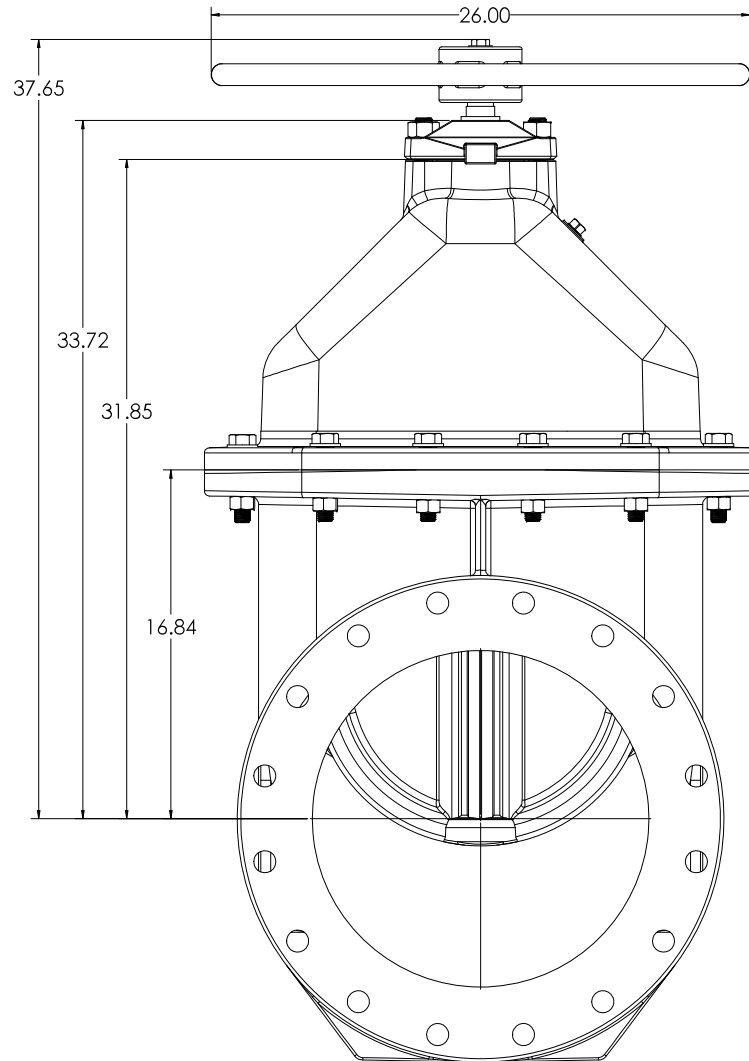

REVISED 2/21/2020 16" CS18 NRS RESILIENT WEDGE GATE VALVE		1:3 SUBMITTAL	3 OF 6	D
DATE: 2/21/2020 TIME: 10:00 BY: JAC	APPROVED: 2/21/2020 TIME: 10:00 BY: JAC	16" CS18 NRS RESILIENT WEDGE GATE VALVE LBS.	3 OF 6	D
16" CS18 NRS RESILIENT WEDGE GATE VALVE LBS.	12/4/2020	1:3	3 OF 6	D

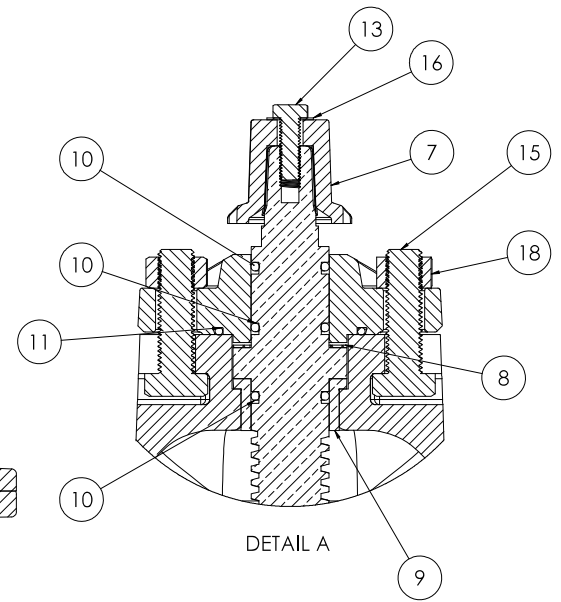
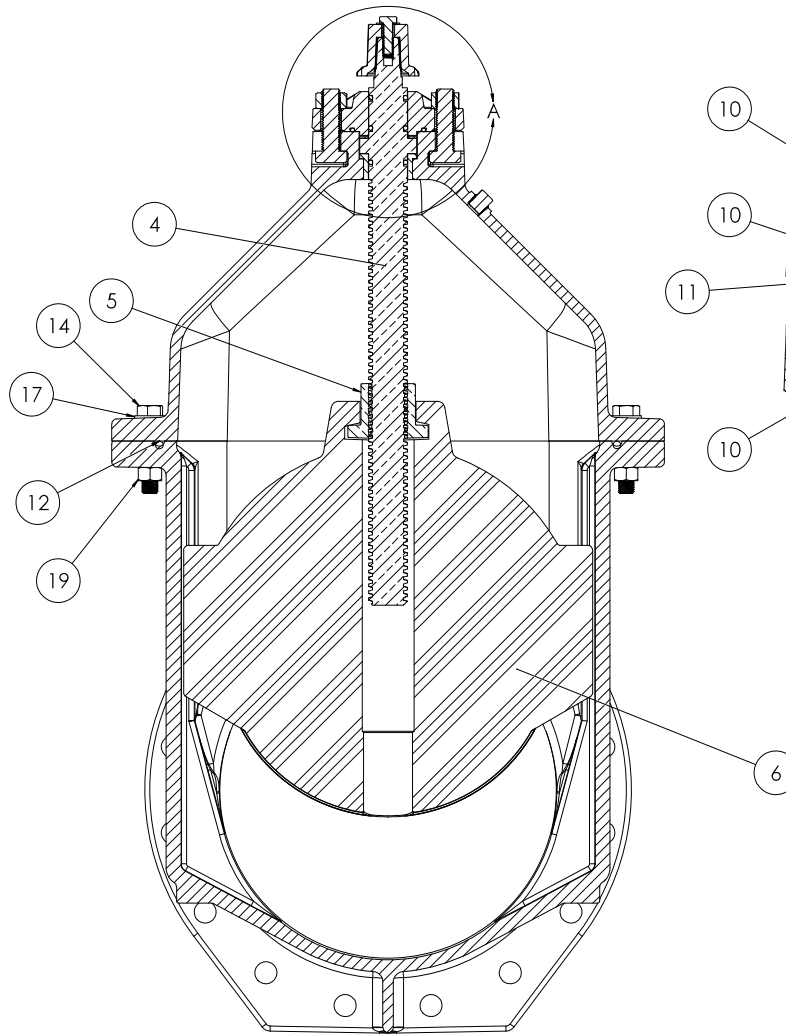
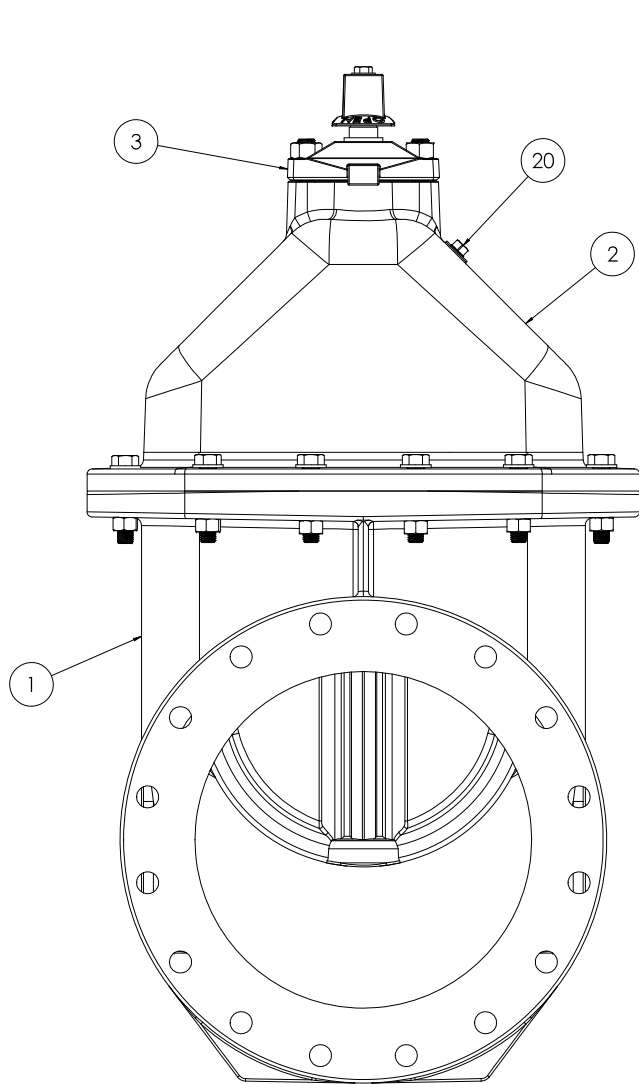

COMPANY: 16" CS18 NRS RESILIENT WEDGE GATE VALVE PART NO: 16" CS18 NRS RESILIENT WEDGE GATE VALVE DATE: 12/24/2020		DRAWN BY: CW CHECKED BY: 12/24/2020 SCALE: 1:3		SHEET NO: 4 TOTAL SHEETS: 6	
PROJECT: 16" CS18 NRS RESILIENT WEDGE GATE VALVE CLIENT: LBS DRAWING NO: 16" CS18 NRS RESILIENT WEDGE GATE VALVE		DATE: 12/24/2020 SCALE: 1:3		SHEET NO: 4 TOTAL SHEETS: 6	



16" CS18 NRS RESILIENT WEDGE GATE VALVE

4

6

1:3

12/24/2020

CW

12/24/2020

1:3

16" CS18 NRS RESILIENT WEDGE GATE VALVE

4

6

1:3

12/24/2020

CW

12/24/2020

1:3

16" CS18 NRS RESILIENT WEDGE GATE VALVE

4

6

1:3

<u>ITEM NO.</u>	<u>COMPONENT</u>	<u>QTY.</u>	<u>DRAWING NUMBER</u>	<u>SIZE</u>	<u>STANDARD MATERIAL</u>	<u>MATERIAL OPTIONS</u>
1	BODY	1	D-20818, D-20819, D-20820, D-20821, D-20194, D-21519, D-22768, D-23193, D-23473	-	DUCTILE IRON	-
2	COVER	1	D-20822	-	DUCTILE IRON	-
3	O-RING PLATE	1	A-23157	-	DUCTILE IRON	-
4	STEM	1	B-20824, B-23485	1 7/8"	C86200	C99500 (LOW ZINC), 304 SS, 316 SS
5	STEM NUT	1	C-20157	-	C87850	C87610 (LOW ZINC)
6	WEDGE	1	D-22089	-	EPDM	-
7	OPERATING NUT	1	D-11243	-	CAST IRON	**26IN HANDWHEEL**
8	THRUST WASHER	1	A-24111	-	NYLATRON	-
9	BUSHING	1	A-23632	-	C87850	-
10	O-RING	3	A-23792	#325	EDPM	BUNA-N
11	O-RING	1	A-23781	#339	EDPM	BUNA-N
12	O-RING	1	A-23741	#463	EDPM	BUNA-N
13	HEX HEAD CAP SCREW	1	A-24028	1/2"-13 X 1 1/2"	18-8 SS	316 SS
14	HEX HEAD CAP SCREW	12	A-23981	3/4"-10 X 3 3/4"	18-8 SS	316 SS
15	HEX HEAD CAP SCREW	2	A-23974	7/8"-9 X 3 1/2"	18-8 SS	316 SS
16	WASHER	1	A-23652	1/2"	18-8 SS	316 SS
17	WASHER	12	A-23644	3/4"	18-8 SS	316 SS
18	HEX NUT	2	A-23849	7/8"-9	18-8 SS	316 SS
19	HEX NUT	12	A-23852	3/4"-10	18-8 SS	316 SS
20	PIPE PLUG	1	A-23674	1/2" - NPT	304 SS	316 SS

- VALVES CONFORM WITH FOLLOWING STANDARDS
 - AWWA C515
 - NSF 61
- LOW ZINC BRASS STEM AND STEM NUT AVAILABLE
- 100% DOMESTIC FASTENER AND O-RING OPTIONS AVAILABLE
- OPEN LEFT (COUNTERCLOCKWISE) AND OPEN RIGHT (CLOCKWISE) OPTIONS AVAILABLE
- TURNS TO OPEN FROM FULLY CLOSED: 52 (+/- 5%)
- AWWA MAXIMUM ALLOWABLE CLOSING TORQUE 750 FT-LBS
- OPTIONAL HANDWHEEL CAN BE SUBSTITUTED FOR STANDARD 2" SQUARE OP NUTS
 - **NOTE: STANDARD HANDWHEEL SIZE CALLED OUT IN PARTS LIST**

<small> COMPANY: SOLOWORKS ADDRESS: 1224 W. 12TH AVE., SUITE 100, DENVER, CO 80202 PHONE: 303.733.8800 FAX: 303.733.8801 WWW: www.soloworks.com </small>	<small> PROJECT: 16" CS18 NRS RESILIENT WEDGE GATE VALVE DATE: 12/24/2020 DRAWN BY: CS CHECKED BY: CS APPROVED BY: CS </small>	<small> SCALE: 1:3 SHEET NO: 6 TOTAL SHEETS: 6 </small>	
--	--	--	---