

**OPERATING NUT WITH
O-RING PLATE**

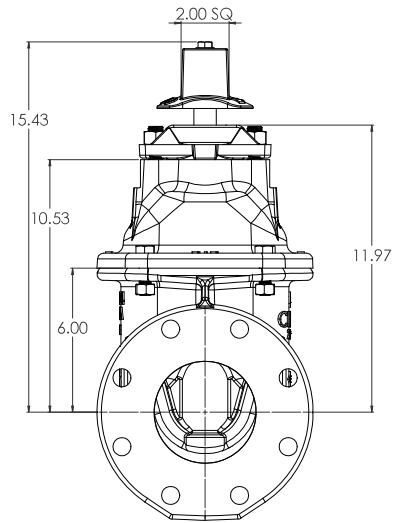

**OPERATING NUT WITH
INDICATOR POST PLATE**

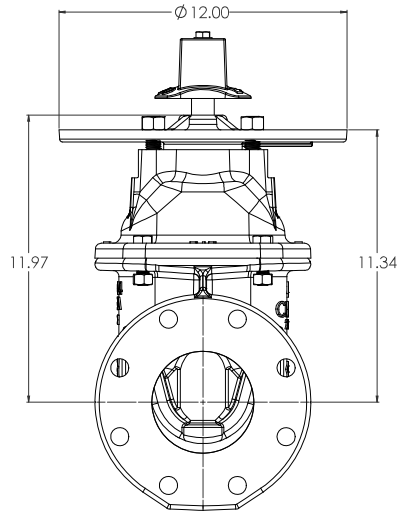

**HANDWHEEL WITH
O-RING PLATE**

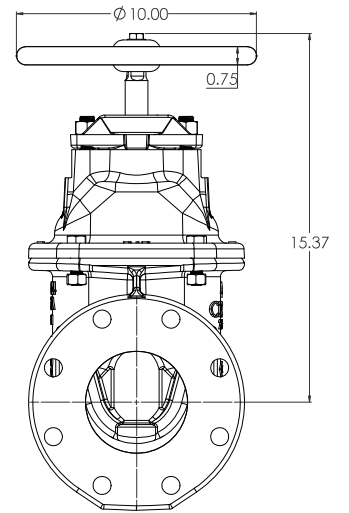

OPERATING NUT WITH O-RING PLATE OPERATING NUT WITH INDICATOR POST PLATE HANDWHEEL WITH O-RING PLATE	15.43 10.53 6.00 2.00 SQ 11.97	Ø 12.00 11.97 11.34	Ø 10.00 0.73 15.37	3 6
---	--	---------------------------	--------------------------	--------

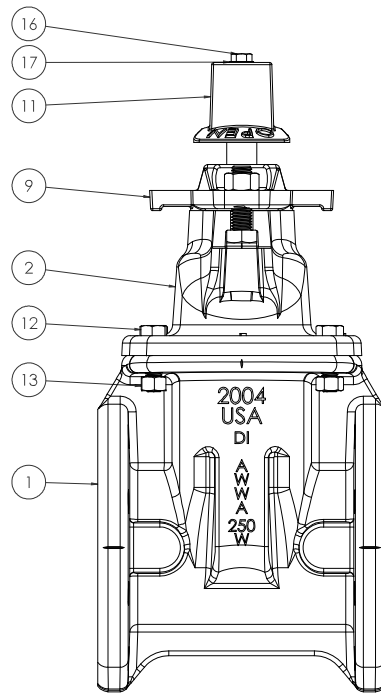
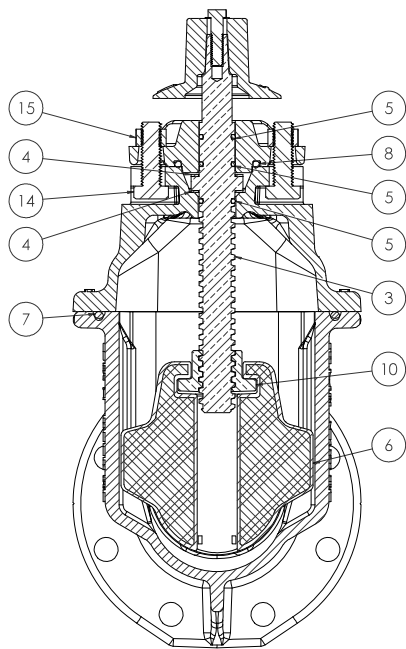

COMPANY WILSON JONES & COMPANY 1000 W. 10th St. Grand Rapids, MI 49503 TEL: (616) 233-1100 FAX: (616) 233-1101 WWW: www.wilsonjones.com	PROJECT 0001000000 DATE 01/10/2004 DRAWN J. JONES CHECKED J. JONES	TITLE 2004 USA DI A W W A 250 W WEDGE GATE VALVE	SCALE 1:1	SHEET NO. 4	TOTAL SHEETS 6	APPROVED J. JONES	DATE 01/10/2004	REVISIONS 1. 01/10/2004 2. 01/10/2004 3. 01/10/2004 4. 01/10/2004 5. 01/10/2004 6. 01/10/2004	16
---	---	--	--------------	----------------	-------------------	----------------------	--------------------	---	----

<u>ITEM NO.</u>	<u>COMPONENT</u>	<u>QTY.</u>	<u>SIZE</u>	<u>STANDARD MATERIAL</u>	<u>MATERIAL OPTIONS</u>
1	BODY	1	-	DUCTILE IRON	-
2	COVER	1	-	DUCTILE IRON	-
3	STEM	1	-	C86200	C99500 (LOW ZINC), 304 SS, 316 SS
4	THRUST WASHER	2	-	ACETAL	C26000
5	O-RING	3	#212	EPDM	BUNA-N
6	WEDGE	1	-	EPDM/DUCTILE IRON	-
7	O-RING	1	#437	EPDM	BUNA-N
8	O-RING	1	#331	EPDM	BUNA-N
9	O-RING PLATE	1	-	DUCTILE IRON	-
10	STEM NUT	1	-	C87850	C87610 (LOW ZINC)
11	OPERATING NUT	1	-	CAST IRON	DUCTILE IRON, C86700, **10" DIA. HANDWHEEL**
12	HEX HEAD CAP SCREW	4	5/8"-11 X 1 3/4"	18-8 SS	316 SS
13	HEX NUT	4	1/2"-13	18-8 SS	316 SS
14	HEX HEAD CAP SCREW	2	5/8"-11 X 2"	18-8 SS	316 SS
15	HEX NUT	2	5/8"-11	18-8 SS	316 SS
16	HEX HEAD CAP SCREW	1	3/8"-16 X 1 1/2"	18-8 SS	316 SS
17	WASHER	1	3/8"	18-8 SS	316 SS

- VALVES CONFORM WITH THE FOLLOWING STANDARDS
 - AWWA C515
 - NSF 61
- LOW ZINC BRASS STEM AND STEM NUT AVAILABLE
- 100% DOMESTIC FASTENERS AND ORINGS OPTIONS AVAILABLE
- *OPEN LEFT* (COUNTERCLOCKWISE) AND *OPEN RIGHT* (CLOCKWISE) OPTIONS AVAILABLE
- TURNS TO OPEN FROM FULLY CLOSED: 12
- AWWA MAXIMUM ALLOWABLE CLOSING TORQUE 75 FT-LBS
- OPTIONAL HANDWHEEL CAN BE SUBSTITUTED FOR STANDARD 2" SQUARE OP. NUTS.
 - **NOTE: STANDARD HANDWHEEL SIZE LISTED OUT IN PARTS LIST.**

<small> COMPANY: WATTS ADDRESS: 1000 W. 10TH ST. SUITE 100 DENVER, CO 80202 TEL: 303.733.1100 FAX: 303.733.1101 WWW: www.watts.com </small>	<small> PROJECT: 1000 W. 10TH ST. SUITE 100 DRAWING: 1000 W. 10TH ST. SUITE 100 DATE: 01/11/2020 BY: CM </small>	<small> TITLE: 1000 W. 10TH ST. SUITE 100 SCALE: 1:10 SHEET: 5 OF 6 REVISION: 1 </small>	<small> MODEL: 1000 W. 10TH ST. SUITE 100 PART: 1000 W. 10TH ST. SUITE 100 QTY: 1 </small>	<small> DATE: 01/11/2020 TIME: 1:10 USER: CM STATUS: 1:10 </small>	<small> PROJECT: 1000 W. 10TH ST. SUITE 100 DRAWING: 1000 W. 10TH ST. SUITE 100 DATE: 01/11/2020 BY: CM </small>	<small> TITLE: 1000 W. 10TH ST. SUITE 100 SCALE: 1:10 SHEET: 5 OF 6 REVISION: 1 </small>	<small> MODEL: 1000 W. 10TH ST. SUITE 100 PART: 1000 W. 10TH ST. SUITE 100 QTY: 1 </small>	<small> DATE: 01/11/2020 TIME: 1:10 USER: CM STATUS: 1:10 </small>	<small> PROJECT: 1000 W. 10TH ST. SUITE 100 DRAWING: 1000 W. 10TH ST. SUITE 100 DATE: 01/11/2020 BY: CM </small>	<small> TITLE: 1000 W. 10TH ST. SUITE 100 SCALE: 1:10 SHEET: 5 OF 6 REVISION: 1 </small>	<small> MODEL: 1000 W. 10TH ST. SUITE 100 PART: 1000 W. 10TH ST. SUITE 100 QTY: 1 </small>	<small> DATE: 01/11/2020 TIME: 1:10 USER: CM STATUS: 1:10 </small>
---	---	--	---	---	---	--	---	---	---	--	---	---